

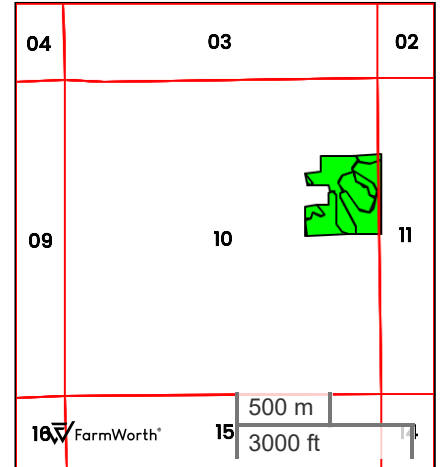

MUDDERMAN FARM  
TOTAL SOILS

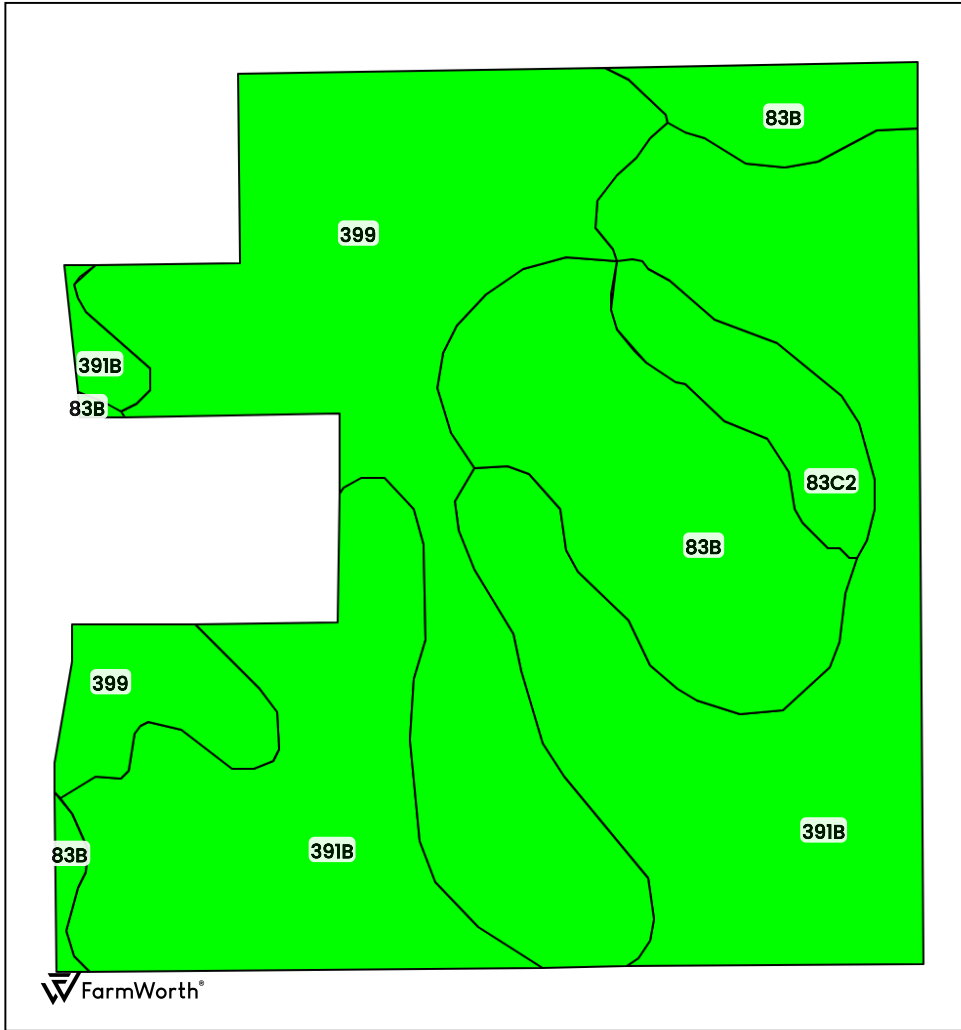

County: **Buchanan County, IA**  
 Location: **10-89N-9W**  
 Township: **Washington**  
 Acres: **34.10**  
 Date: **07/07/2026**



FarmWorth, LLC makes no warranties, express or implied, regarding the accuracy of any information provided through FarmWorth.com. User is solely responsible for independently verifying all information prior to use and waives any claims against FarmWorth, LLC arising from inaccuracies in such information.

Code	Description	Acres	% of field	IA CSR2	Soil Class (Non-Irr)	Drainage Class
391B	Clyde-Floyd complex, 1 to 4 percent slopes	15.45	45.29 %	87	2	Poorly drained
399	Readlyn silt loam, 1 to 3 percent slopes	11.02	32.31 %	91	1	Somewhat poorly drained
83B	Kenyon loam, 2 to 5 percent slopes	6.18	18.12 %	90	2	Moderately well drained
83C2	Kenyon loam, 5 to 9 percent slopes, eroded	1.46	4.28 %	84	3	Moderately well drained
				<b>Average:</b>	<b>88.7</b>	

IA has updated the CSR values for each county to CSR2.  
 Soils data provided by USDA and NRCS.